

**CONCLUSION:**



SPECIFIC DEMOLITION NOTES - SHEET A5.0	
TAG#	DEMOLITION NOTE
07-01	REMOVE EXISTING COPING CAP / GRAVEL STOP. PARAPET WALL AND BUILT-UP ROOFING SYSTEM, AS REQUIRED TO RECEIVE NEW CONSTRUCTION. REFER TO ARCHITECTURAL DRAWINGS FOR EXTENTS
07-02	REMOVE BUILT-UP ROOF SYSTEM, ROOF INSULATION, METAL DECK, DOWN TO SLEET, STRUCTURE - REFER TO STRUCTURAL DRAWING FOR EXISTING ROOF STRUCTURE
07-03	REMOVE CANOPY ROOF AND STRUCTURE IN ITS ENTIRETY. REFER TO ARCHITECTURE AND STRUCTURE FOR ADDITIONAL DRAWING AND NEW CONSTRUCTION OF STRUCTURE
07-04	REMOVE EXISTING ROOF DRAIN. REFER TO PLUMBING DRAWINGS FOR EXISTING RAIN WATER LEADERS
07-05	REMOVE VINYL CANOPY AND BRACKET IN THEIR ENTIRETY.
07-08	REMOVE ASPHALT SHINGLES, FLASHING PLYWOOD SHEATHING AND WOOD STRUCTURE IN ITS ENTIRETY





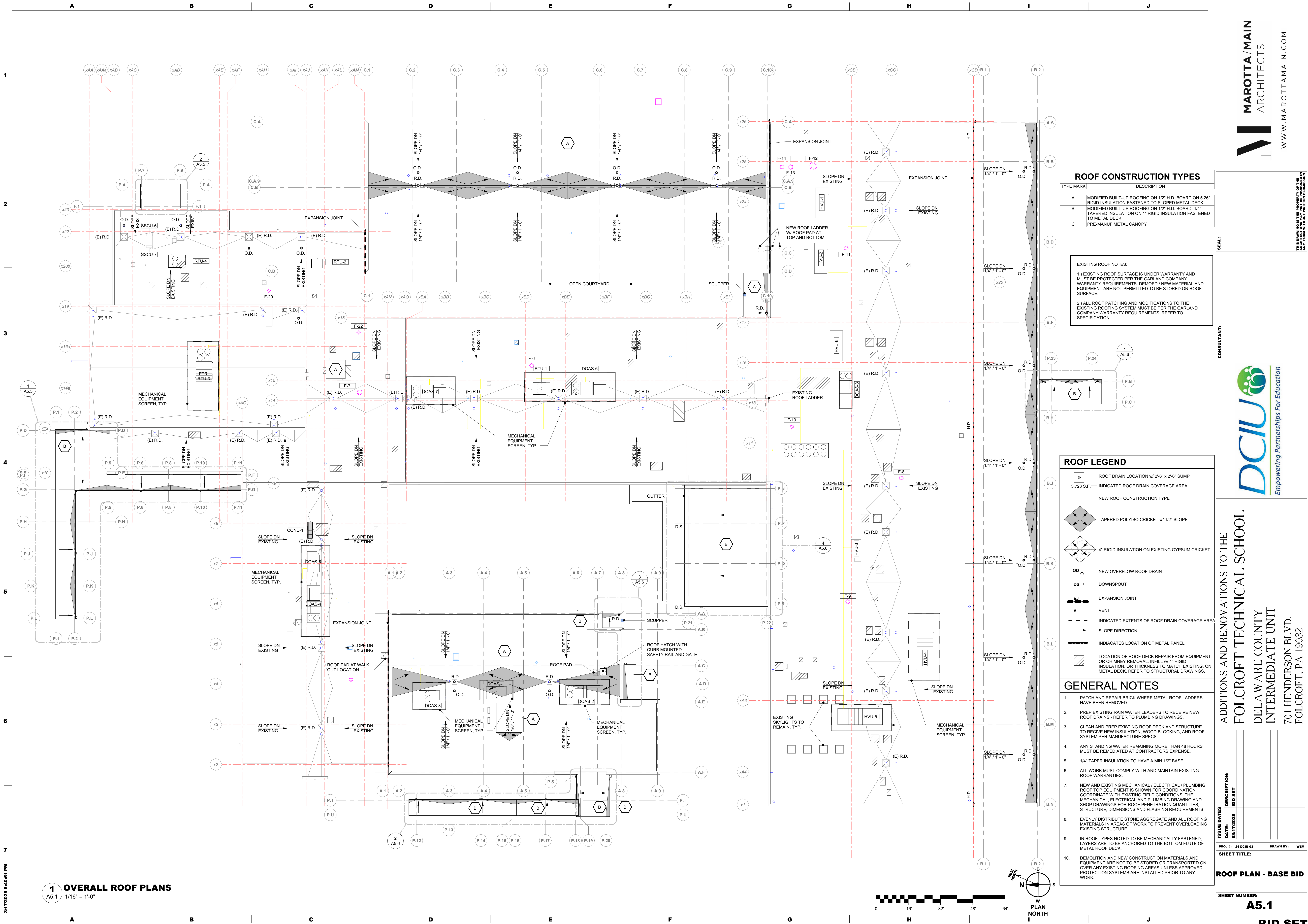

ROOF CONSTRUCTION TYPES	
TYPE MARK	DESCRIPTION
A	MODIFIED BUILT-UP ROOFING ON 1/2" H.D. BOARD ON 5/8" RIGID INSULATION FASTENED TO SLOPED METAL DECK
B	MODIFIED BUILT-UP ROOFING ON 1/2" H.D. BOARD, 1/4" TAPERED INSULATION ON 1" RIGID INSULATION FASTENED TO METAL DECK
C	PRE-MANUF METAL CANOPY

EXISTING ROOF NOTES:

- 1) EXISTING ROOF SURFACE IS UNDER WARRANTY AND MUST BE PROTECTED PER THE GARLAND COMPANY WARRANTY REQUIREMENTS. DEMOLISHED / NEW MATERIAL AND EQUIPMENT ARE NOT PERMITTED TO BE STORED ON ROOF SURFACE.
- 2) ALL ROOF PATCHING AND MODIFICATIONS TO THE EXISTING ROOFING SYSTEM MUST BE PER THE GARLAND COMPANY WARRANTY REQUIREMENTS. REFER TO SPECIFICATION.

ROOF LEGEND	
	ROOF DRAIN LOCATION w/ 2'-6" x 2'-6" SUMP
	3,723 S.F. INDICATED ROOF DRAIN COVERAGE AREA
NEW ROOF CONSTRUCTION TYPE	
	TAPERED POLYISO CRICKET w/ 1/2" SLOPE
	4" RIGID INSULATION ON EXISTING GYPSUM CRICKET
	NEW OVERFLOW ROOF DRAIN
	DOWNSPOUT
	EXPANSION JOINT
	VENT
	INDICATED EXTENTS OF ROOF DRAIN COVERAGE AREA
	SLOPE DIRECTION
	INDICATES LOCATION OF METAL PANEL
	LOCATION OF ROOF DECK REPAIR FROM EQUIPMENT OR CHIMNEY REMOVAL, INFILL w/ 4" RIGID INSULATION, OR THICKNESS TO MATCH EXISTING, ON METAL DECK. REFER TO STRUCTURAL DRAWINGS.

- GENERAL NOTES**
1. PATCH AND REPAIR BRICK WHERE METAL ROOF LADDERS HAVE BEEN REMOVED.
  2. PREP EXISTING RAIN WATER LEADERS TO RECEIVE NEW ROOF DRAIN. REFER TO PLUMBING DRAWINGS.
  3. CLEAN AND PREP EXISTING ROOF DECK AND STRUCTURE TO RECEIVE NEW INSULATION, WOOD BLOCKING, AND ROOF SYSTEM PER MANUFACTURE SPECS.
  4. ANY STANDING WATER REMAINING MORE THAN 48 HOURS MUST BE REMEDIATED AT CONTRACTORS EXPENSE.
  5. 1/4" TAPER INSULATION TO HAVE A MIN 1/2" BASE.
  6. ALL WORK MUST COMPLY WITH AND MAINTAIN EXISTING ROOF WARRANTIES.
  7. NEW AND EXISTING MECHANICAL / ELECTRICAL / PLUMBING ROOF TOP EQUIPMENT IS SHOWN FOR COORDINATION. COORDINATE WITH EXISTING FIELD CONDITIONS, THE MECHANICAL, ELECTRICAL AND PLUMBING DRAWING AND SHOP DRAWINGS FOR ROOF PENETRATION QUANTITIES, STRUCTURE, DIMENSIONS AND FLASHING REQUIREMENTS.
  8. EVENLY DISTRIBUTE STONE AGGREGATE AND ALL ROOFING MATERIALS IN AREAS OF WORK TO PREVENT OVERLOADING EXISTING STRUCTURE.
  9. IN ROOF TYPES NOTED TO BE MECHANICALLY FASTENED, LAYERS ARE TO BE ANCHORED TO THE BOTTOM FLUTE OF METAL ROOF DECK.
  10. DEMOLITION AND NEW CONSTRUCTION MATERIALS AND EQUIPMENT ARE NOT TO BE STORED OR TRANSPORTED ON OVER ANY EXISTING ROOFING AREAS UNLESS APPROVED PROTECTION SYSTEMS ARE INSTALLED PRIOR TO ANY WORK.

ADDITIONS AND RENOVATIONS TO THE  
FOLCROFT TECHNICAL SCHOOL  
DELAWARE COUNTY  
INTERMEDIATE UNIT  
701 HENDERSON BLVD.  
FOLCROFT, PA 19032

ISSUE DATES		DESCRIPTION	
DATE	BID SET	DATE	BID SET
03/17/2025			

PROJ # : 21-DCU-03 DRAWN BY : WEM

SHEET TITLE:

ROOF PLAN - BASE BID

SHEET NUMBER:







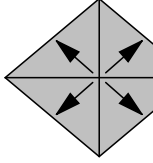
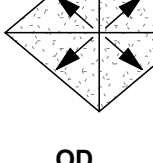

A5.1

BID SET



ROOF CONSTRUCTION TYPES	
TYPE MARK	DESCRIPTION
A	MODIFIED BUILT-UP ROOFING ON 1/2" H.D. BOARD ON 5/8" RIGID INSULATION FASTENED TO SLOPED METAL DECK
D	MODIFIED BUILT-UP ROOFING ON 1/2" H.D. BOARD ADHERED TO 1/4" TAPER INSULATION MECHANICALLY FASTENED TO 2 LAYER OF 2.6" RIGID INSULATION ADHERED TO CONCRETE DECK. APPLY SELF ADHERING VAPOR BARRIER TO CONCRETE DECK
E	MODIFIED BUILT-UP ROOFING ON 1/2" H.D. BOARD ADHERED TO 1/4" TAPER INSULATION MECHANICALLY FASTENED TO 2 LAYER OF 2.6" RIGID INSULATION ADHERED TO PLYWOOD DECK. APPLY SELF ADHERING VAPOR BARRIER TO PLYWOOD DECK

# ROOF LEGEND

	ROOF DRAIN LOCATION w/ 2'-6" x 1'-6" SUMP
3,723 S.F. —	INDICATED ROOF DRAIN COVERAGE AREA
NEW ROOF CONSTRUCTION TYPE	
	TAPERED POLYISO CRICKET w/ 1/2" SLOPE
	4" RIGID INSULATION ON EXISTING GYPSUM CRICKET
OD 	NEW OVERFLOW ROOF DRAIN
DS 	DOWNSPOUT
 EJ	EXPANSION JOINT
V 	VENT
— — —	INDICATED EXTENTS OF ROOF DRAIN COVERAGE AREA
	SLOPE DIRECTION
	INDICATES LOCATION OF METAL PANEL
	LOCATION OF ROOF DECK REPAIR FROM EQUIPMENT OR CHIMNEY REMOVAL. INFILL w/ 1/2" RIGID INSULATION ON METAL DECK. REFER TO STRUCTURAL DRAWINGS.

- ## GENERAL NOTES
1. PATCH AND REPAIR BRICK WHERE METAL ROOF LADDERS HAVE BEEN REMOVED.
  2. PREP EXISTING RAIN WATER LEADERS TO RECEIVE NEW ROOF DRAINS - REFER TO PLUMBING DRAWINGS.
  3. CLEAN AND PREP EXISTING ROOF DECK AND STRUCTURE TO RECEIVE NEW INSULATION, WOOD BLOCKING, AND ROOF SYSTEM PER MANUFACTURE SPECS.
  4. ANY STANDING WATER REMAINING MORE THAN 48 HOURS MUST BE REMEDIATED AT CONTRACTORS EXPENSE.
  5. 1/4" TAPER INSULATION TO HAVE A MIN 1/2" BASE.

ADDITIONS AND RENOVATIONS TO THE  
FOLCROFT TECHNICAL SCHOOL  
DELAWARE COUNTY  
INTERMEDIATE UNIT  
701 HENDERSON BLVD.  
FOLCROFT, PA 19032

ISSUE DATES	
DATE:	DESCRIPTION:

PROJ #: 21-DCIU-03      DRAWN BY: KLG

**SHEET TITLE:**

### ROOF PLAN - ALT 3

**SHEET NUMBER:**

### A5.1.3

## BID SET

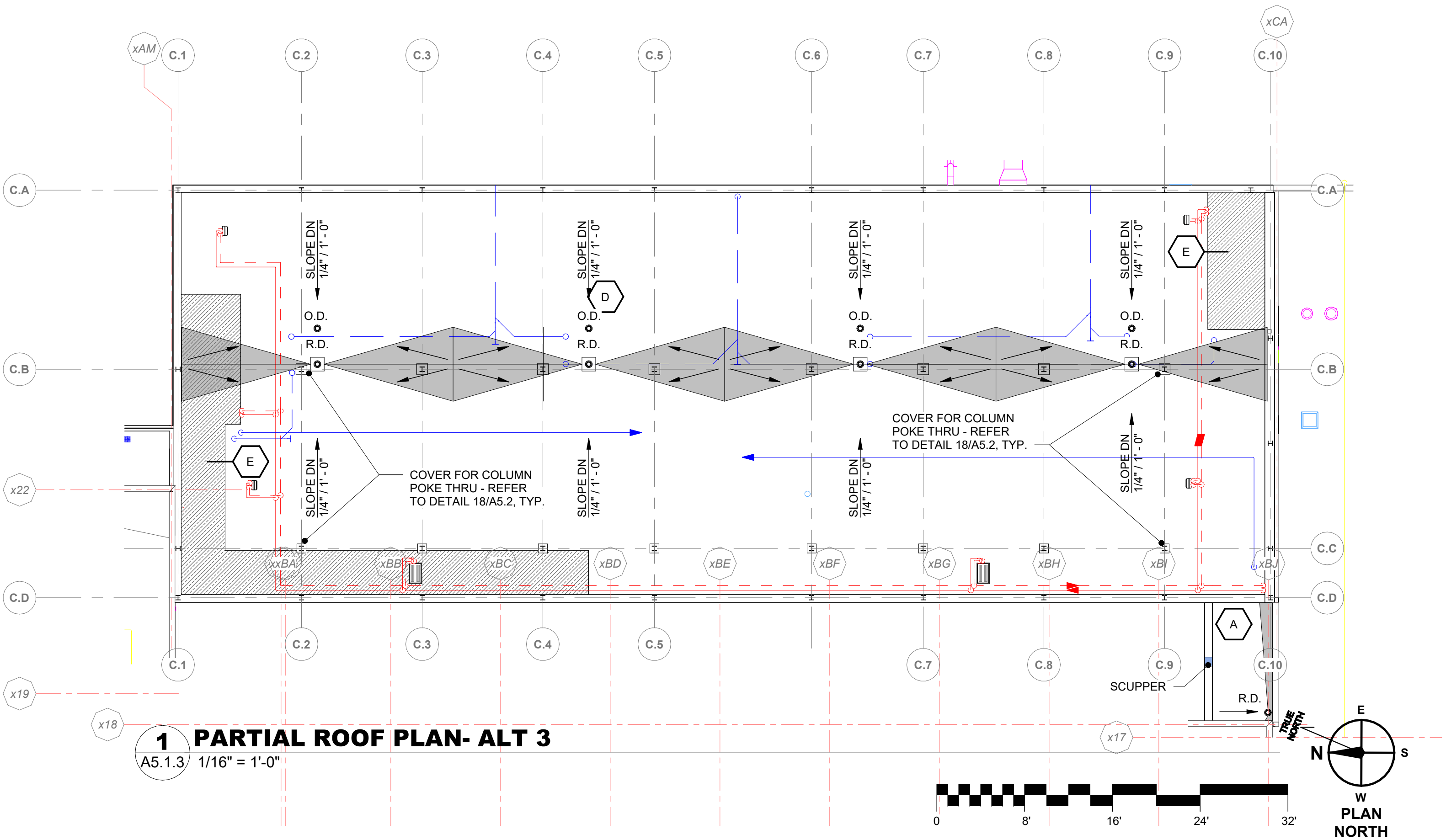



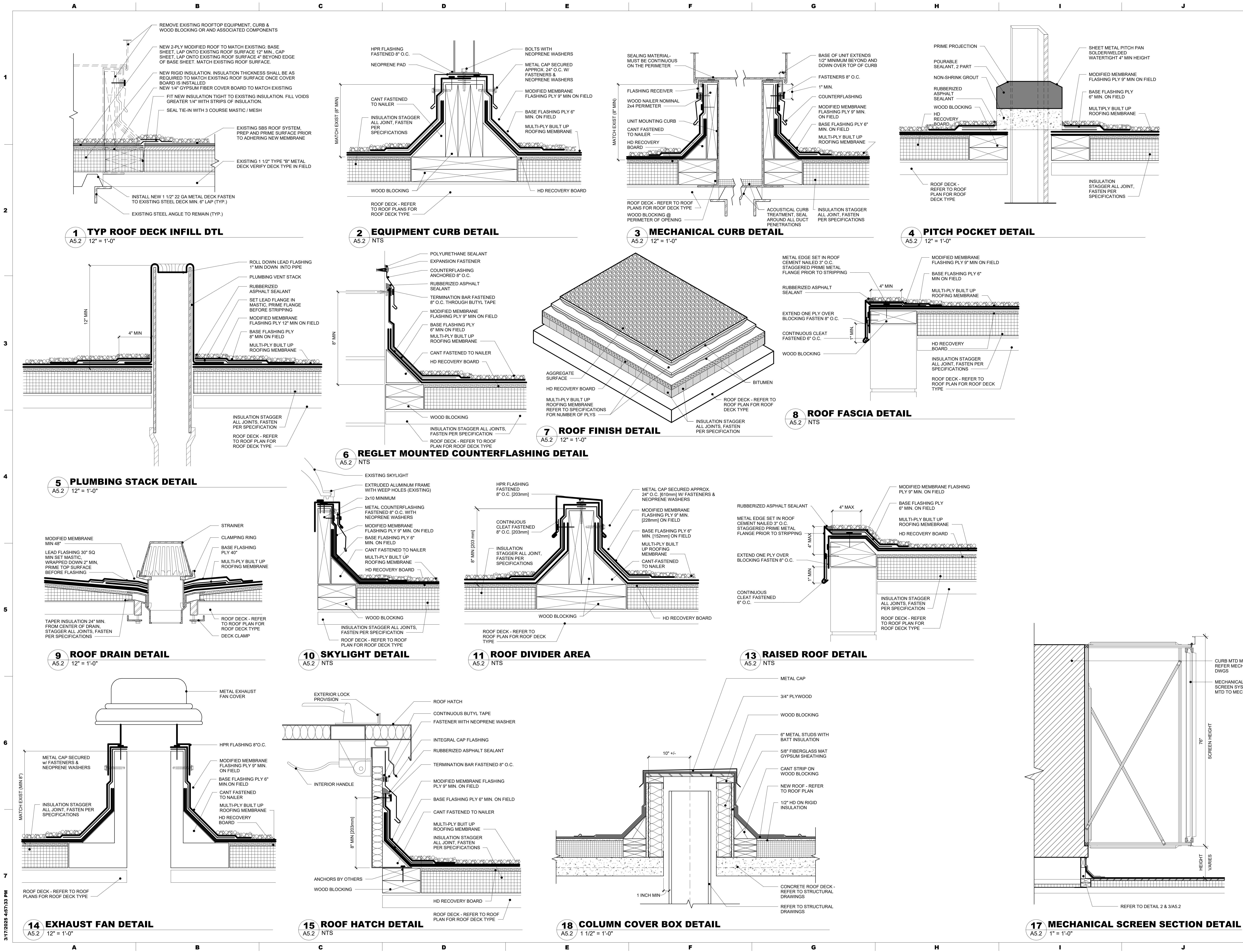

MAROTTA/MAIN  
ARCHITECTS

WWW.MAROTTAMAIN.COM

SEAL:

CONSULTANT:

DCIU  
Empowering Partnerships For Education

ADDITIONS AND RENOVATIONS TO THE  
FOLCROFT TECHNICAL SCHOOL  
DELAWARE COUNTY  
INTERMEDIATE UNIT  
701 HENDERSON BLVD.  
FOLCROFT, PA 19032

ISSUE DATES  
DATE: 03/17/2025  
DESCRIPTION: BID SET

PROJ # : 21-DCIU-03  
SHEET TITLE:  
TYPICAL ROOF  
DETAILS - EXISTING  
CONSTRUCTION

SHEET NUMBER:  
A5.2

3/17/2025 4:57:33 PM







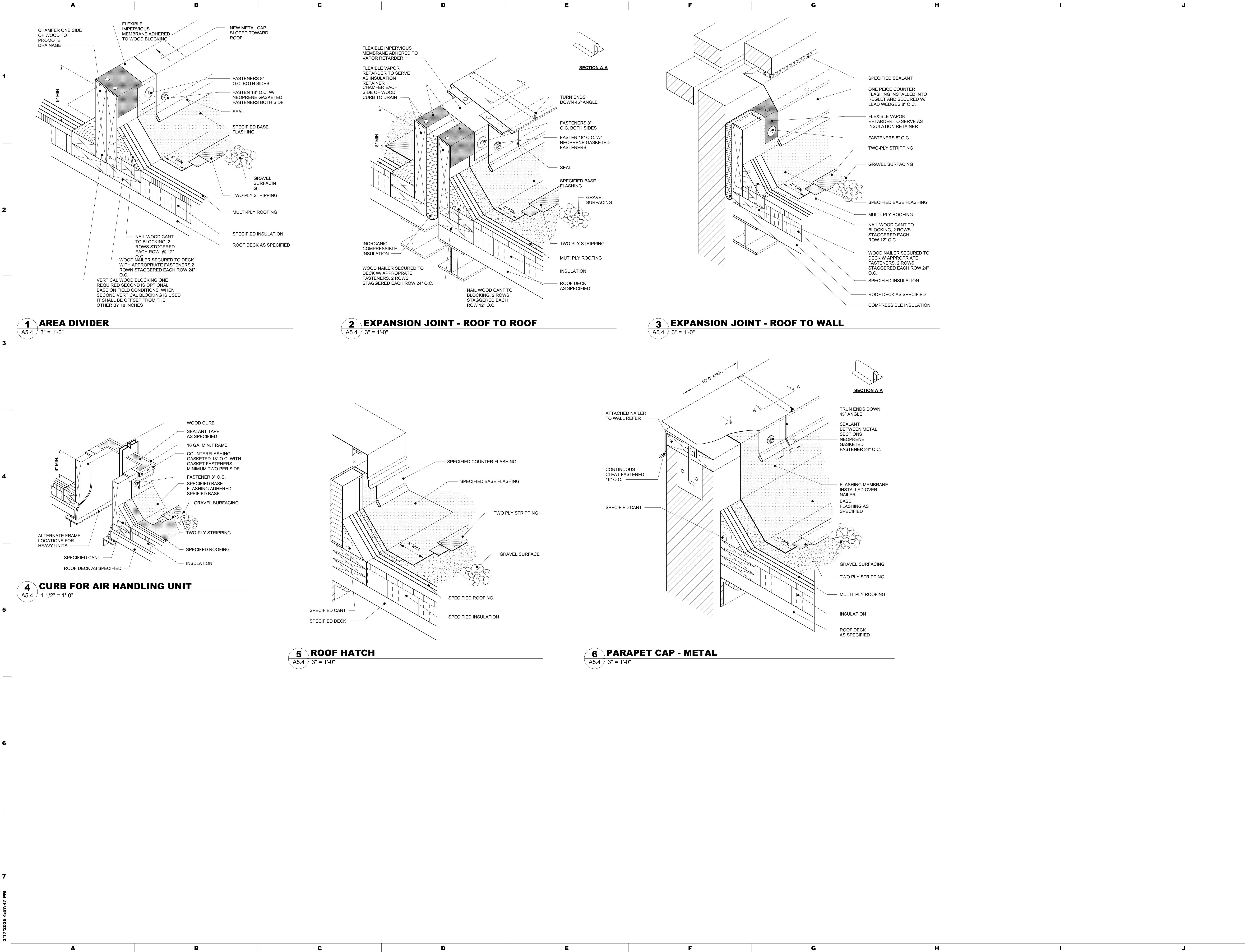

CONSULTANT:



Empowering Partnerships For Education

ADDITIONS AND RENOVATIONS TO THE  
FOLCROFT TECHNICAL SCHOOL  
DELAWARE COUNTY  
INTERMEDIATE UNIT  
701 HENDERSON BLVD.  
FOLCROFT, PA 19032

ISSUE DATES

DATE	DESCRIPTION

PROJ # : 21-DCIU-03

DRAWN BY : WEM

SHEET TITLE:

SHEET NUMBER:

TYPICAL ROOF DETAIL  
- NEW CONSTRUCTION

A5.4

BID SET

MAROTTA /MAIN  
ARCHITECTS

WWW.MAROTTAMAIN.COM

SEAL:

THIS DRAWING IS THE PROPERTY OF THE  
FIRM. IT IS NOT TO BE REPRODUCED OR  
COPYED IN ANY FORM WITHOUT WRITTEN PERMISSION

3/17/2025 4:57:47 PM



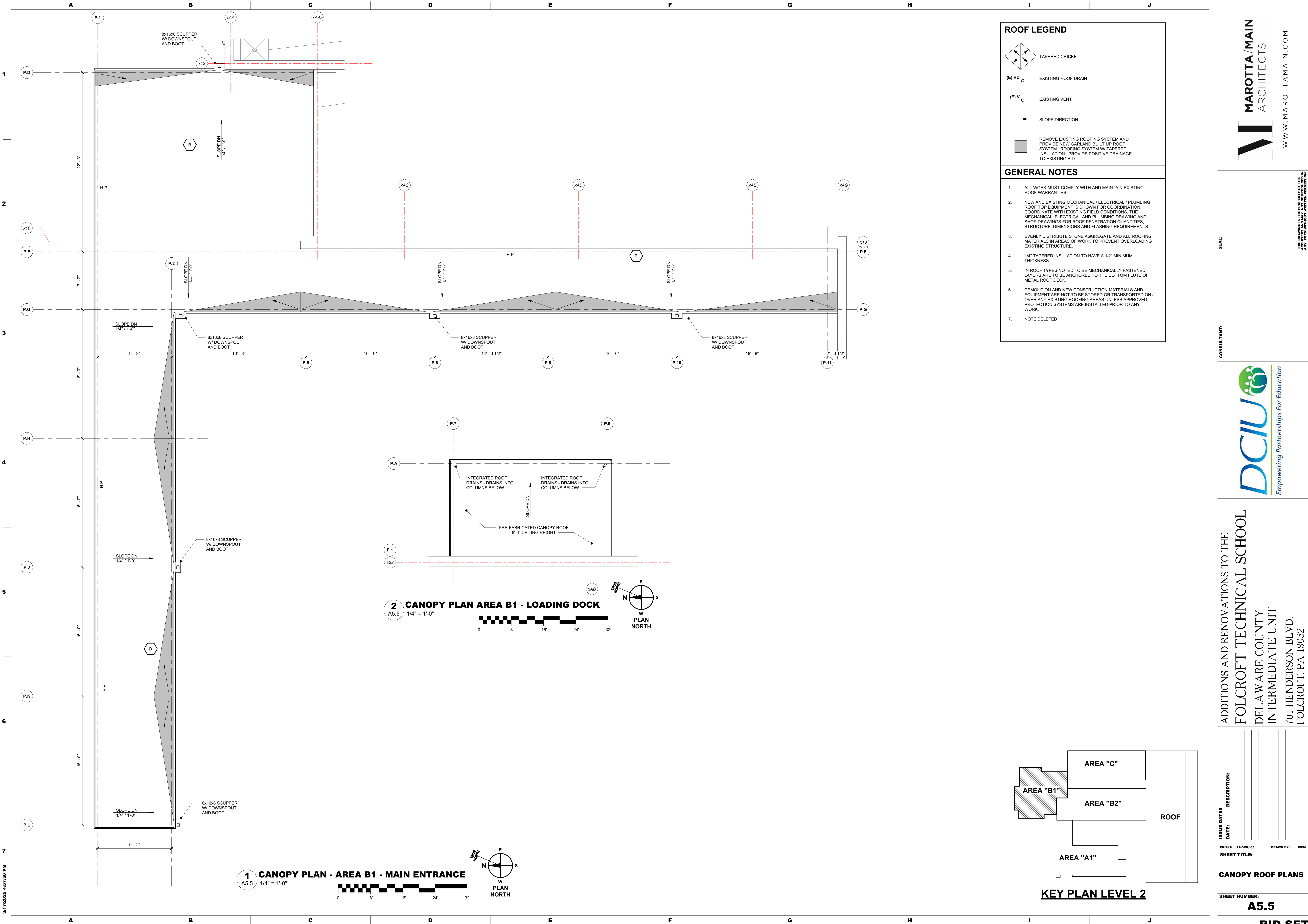

ROOF LEGEND

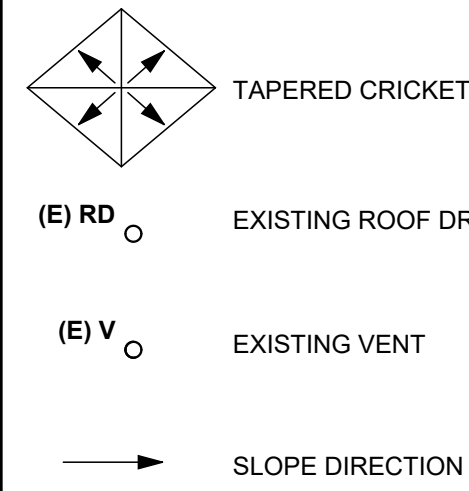

REMOVE EXISTING ROOFING SYSTEM AND PROVIDE NEW GARLAND BUILT UP ROOF SYSTEM. ROOFING SYSTEM W/ TAPERED INSULATION. PROVIDE POSITIVE DRAINAGE TO EXISTING R.D.

GENERAL NOTES

- ALL WORK MUST COMPLY WITH AND MAINTAIN EXISTING ROOF WARRANTIES.
- NEW AND EXISTING MECHANICAL / ELECTRICAL / PLUMBING ROOF TOP EQUIPMENT IS SHOWN FOR COORDINATION. COORDINATE WITH EXISTING FIELD CONDITIONS. THE MECHANICAL, ELECTRICAL AND PLUMBING DRAWING AND SHOP DRAWINGS FOR ROOF PENETRATION QUANTITIES, STRUCTURE, DIMENSIONS AND FLASHING REQUIREMENTS.
- EVENLY DISTRIBUTE STONE AGGREGATE AND ALL ROOFING MATERIALS IN AREAS OF WORK TO PREVENT OVERLOADING EXISTING STRUCTURE.
- 1/4" TAPERED INSULATION TO HAVE A 1/2" MINIMUM THICKNESS.
- IN ROOF TYPES NOTED TO BE MECHANICALLY FASTENED, LAYERS ARE TO BE MECHANICALLY FASTENED TO THE BOTTOM FLUTE OF METAL ROOF DECK.
- DEMOLITION AND NEW CONSTRUCTION MATERIALS AND EQUIPMENT ARE NOT TO BE STORED OR TRANSPORTED ON / OVER ANY EXISTING ROOFING AREAS UNLESS APPROVED PROTECTION SYSTEMS ARE INSTALLED PRIOR TO ANY WORK.
- NOTE DELETED

CONSULTANT:

