



PROJECT TEAM

Owner
Tredyffrin/Easttown School District
940 West Valley Road, Suite 1700
Wayne, PA 19087
610-240-1900

Architect
Heckendorn Shiles Architects
347 East Conestoga Road
Wayne, PA 19087
610-994-3500

Structural Engineer
A.W. Lookup Corporation
500 Fayette Street, Suite 100
Conshohocken, PA 19428
610-825-2600

MEPFP Engineer
Schiller and Hersh Assoc., Inc.
636 Skippack Pike, Suite 200
Blue Bell, PA 19422

Site/Civil
Pennoni Assoc., Inc.
One South Church Street, 2nd Floor
West Chester, PA 19382

IT Consultant
Teranet Consulting & Technical
Services
215-527-9825

Security
KtecK, Inc.
565 Meadowbrook Ave
Ambler, PA 19002
215-237-7390

Network
Saltant Solutions LLC
PO Box 252
Narberth, PA 19072-1924
267-551-4786

PROJECT

TESD Conestoga Athletic Fields
Tredyffrin Township
Chester County, PA

HSA Project #21-019

ISSUE HISTORY

CD	2024-03-18	Contract Documents
PI	2024-03-15	Progress Issue
MARK	DATE	DESCRIPTION

SHEET TITLE

ABBREVIATIONS,
GENERAL NOTES,
DRAWING LIST

DRAWING NUMBER

T001

LEGEND

<div>ANT</div> <div><div><div>ANT</div><div>MNT WAP ID</div></div></div>	WIRELESS ACCESS POINT LEADER, IF PRESENT, IDENTIFIES APPROX. MOUNTING LOCATION
<div>ROOM NAME</div> <div><div>101</div></div>	ROOM ID
<div>MOD</div> <div><div>SW</div><div>MNT ID</div></div>	NETWORK SWITCH
<div>MOD</div> <div><div>UPS</div><div>MNT ID</div></div>	UNINTERRUPTIBLE POWER SUPPLY LEADER, IF PRESENT, IDENTIFIES APPROX. MOUNTING LOCATION
<div><div></div></div>	LOGICAL COMPONENT GROUP
<div><div></div></div>	CONNECTION GROUP
<div><div></div></div>	MULTIPLE CABLES
<div>PLAN NORTH</div> <div><div></div></div>	NORTH ARROW

ABBREVIATIONS

ANTENNA	ANT
APPROXIMATE	APPROX
CATEGORY	CAT
CEILING	C
CLOSED CIRCUIT TELEVISION	CCTV
CONESTOGA HIGH SCHOOL	CHS
DIRECTIONAL	D
ELECTRIC	ELEC
ELECTRICAL CONTRACTOR	EC
EXISTING	E
FIELD HOUSE	FH
GROUND AND FIELDS BUILDING	GFB
IDENTIFICATION	ID
INTERMEDIATE DATA FRAME	IDF
INFORMATION TECHNOLOGY	IT
JUNCTION BOX	J-BOX
JANITOR	JAN
LONG REACH	LR
MAIN DATA FRAME	MDF
MODIFIER	MOD
MOUNTING	MNT
NETWORK OPERATIONS CENTER	NOC
NOT TO SCALE	NTS
ONLINE	ONL
OUTSIDE WALL	OW
POLE	P
PATCH PANEL	PP
PROGRESS ISSUE	PI
RACK	RK
STRUCTURE	S
SMALL FORM-FACTOR PLUGGABLE	SFP
SECURITY SYSTEM INSTALLER	SSI
SHIELDED TWISTED PAIR	STP
SINGLE MODE FIBER	SMF
SPECIFICATIONS	SPECS
SWITCH	SW
ULTRA PHYSICAL CONTACT	UPC
UNINTERRUPTIBLE POWER SUPPLY	UPS
VOICE OVER INTERNET PROTOCOL	VOIP
WALL	W
WIRELESS ACCESS POINT	WAP

GENERAL NOTES

- REFER TO SPECIFICATIONS FOR WAP SCHEDULES
- REFER TO EC DOCUMENTS FOR DETAILS
ANNOTATED "(EC)"
- COORDINATE FINAL CEILING WAP MOUNTING
LOCATIONS AND ATTACHMENTS IN THE FIELD TO
OPTIMIZEFOR COVERAGE AND SERVICEABILITY
WHILE AVOIDING CONFLICTS WITH OTHER
FIXTURES, DEVICES, AND EQUIPMENT

DRAWING LIST

NUMBER	NAME	2024-03-15 PROGRESS ISSUE	2024-03-18 CONTRACT DOCUMENTS
T001	ABBREVIATIONS, GENERAL NOTES, DRAWING LIST	●	●
T100	SITE PLAN	●	●
T101	FIRST FLOOR PLAN—FIELD HOUSE AND GROUNDS & FIELDS BUILDING	●	●
T600	SINGLE LINE DIAGRAM	●	●

SITE LOCATION MAP

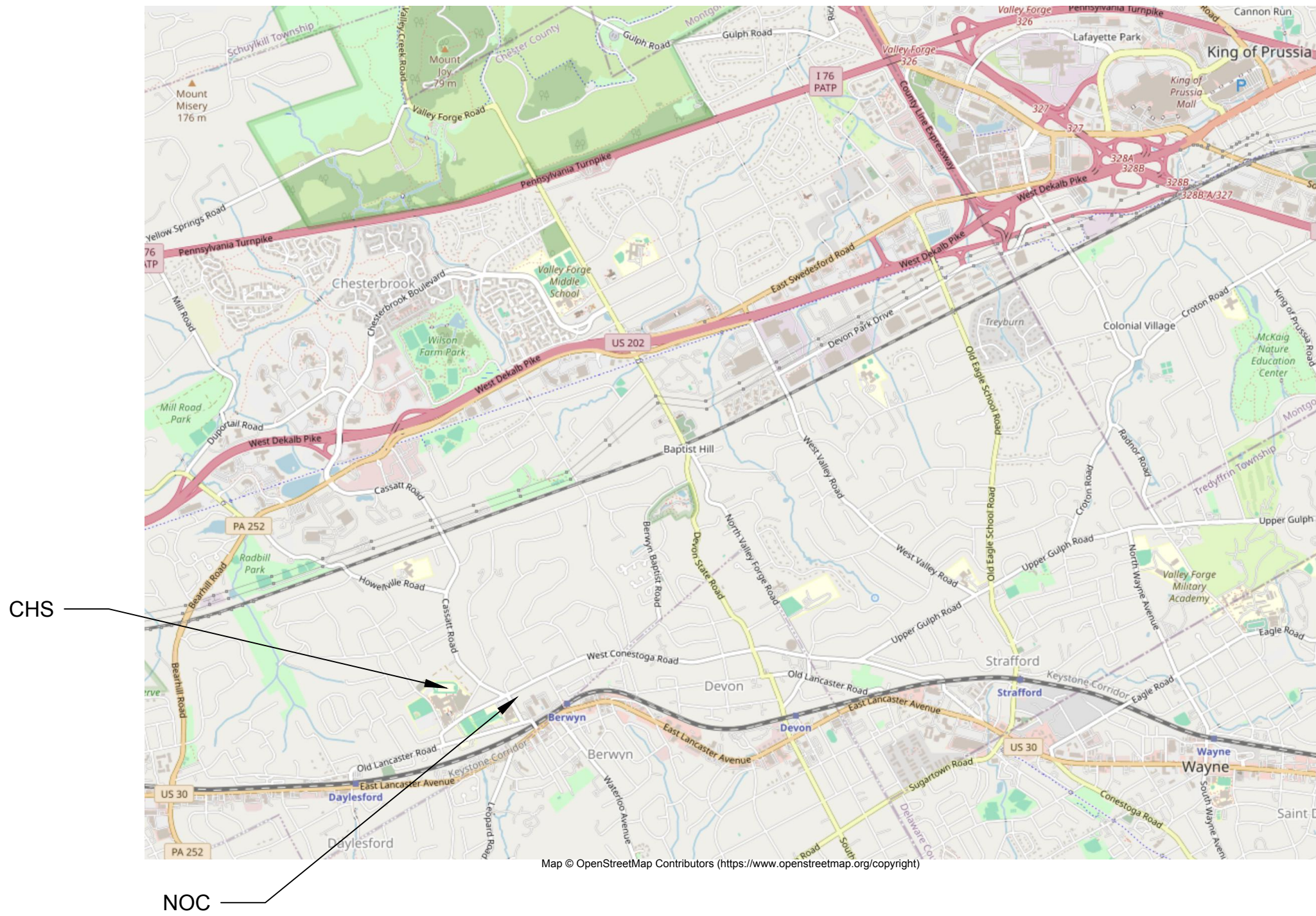

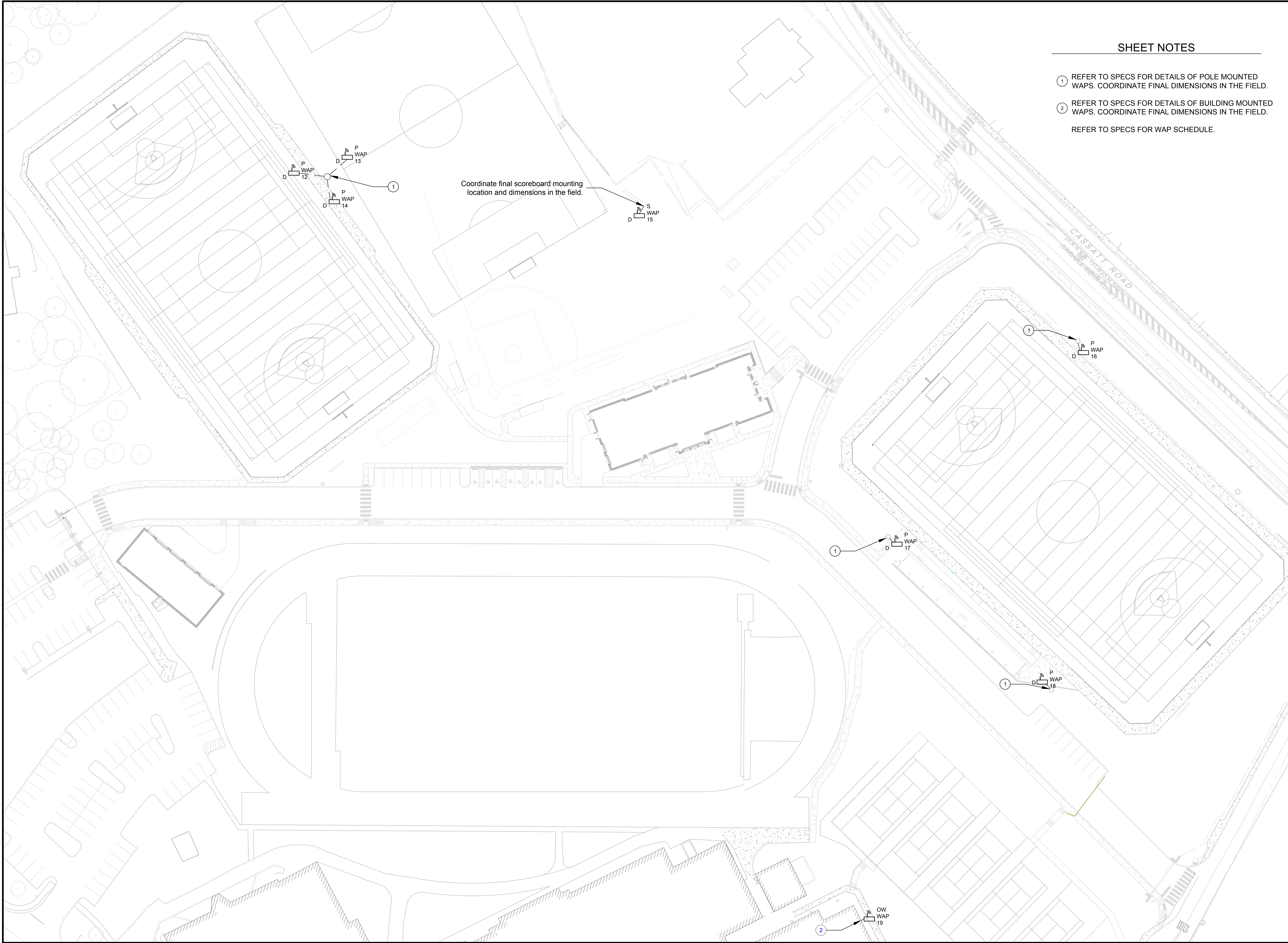

PROJECT TEAM

Owner
Tredyffrin/Easttown School District
940 West Valley Road, Suite 1700
Wayne, PA 19087
610-240-1900

Architect
Heckendorn Shiles Architects
347 East Conestoga Road
Wayne, PA 19087
610-994-3500

Structural Engineer
A.W. Lookup Corporation
500 Fayette Street, Suite 100
Conshohocken, PA 19428
610-825-2600

MEFP Engineer
Schiller and Hersh Assoc., Inc.
636 Skippack Pike, Suite 200
Blue Bell, PA 19422

Site/Civil
Pennoni Assoc., Inc.
One South Church Street, 2nd Floor
West Chester, PA 19382

IT Consultant
Teranet Consulting & Technical
Services
215-527-9825

Security
KtecK, Inc.
565 Meadowbrook Ave
Ambler, PA 19002
215-237-7390

Network
Saltant Solutions LLC
PO Box 252
Narberth, PA 19072-1924
267-551-4786



PROJECT

TESD Conestoga Athletic Fields
Tredyffrin Township
Chester County, PA

HSA Project #21-019

ISSUE HISTORY

CD	2024-03-18	Contract Documents
PI	2024-03-15	Progress Issue
MARK	DATE	DESCRIPTION

SHEET TITLE

SITE PLAN

DRAWING NUMBER

T100



PROJECT TEAM

Owner
Tredyffrin/Easttown School District
940 West Valley Road, Suite 1700
Wayne, PA 19087
610-240-1900

Architect
Heckendorn Shiles Architects
347 East Conestoga Road
Wayne, PA 19087
610-994-3500

Structural Engineer
A.W. Lookup Corporation
500 Fayette Street, Suite 100
Conshohocken, PA 19428
610-825-2600

MEPFP Engineer
Schiller and Hersh Assoc., Inc.
636 Skippack Pike, Suite 200
Blue Bell, PA 19422

Site/Civil
Pennoni Assoc., Inc.
One South Church Street, 2nd Floor
West Chester, PA 19382

IT Consultant
Teranet Consulting & Technical
Services
215-527-9825

Security
KtecK, Inc.
565 Meadowbrook Ave
Ambler, PA 19002
215-237-7390

Network
Saltant Solutions LLC
PO Box 252
Narberth, PA 19072-1924
267-551-4786

PROJECT

TESD Conestoga Athletic Fields
Tredyffrin Township
Chester County, PA

HSA Project #21-019

ISSUE HISTORY

CD	2024-03-18	Contract Documents
PI	2024-03-15	Progress Issue
MARK	DATE	DESCRIPTION

SHEET TITLE

**FIRST FLOOR
PLAN—FIELD HOUSE
AND GROUNDS &
FIELDS BUILDING**

DRAWING NUMBER

T101

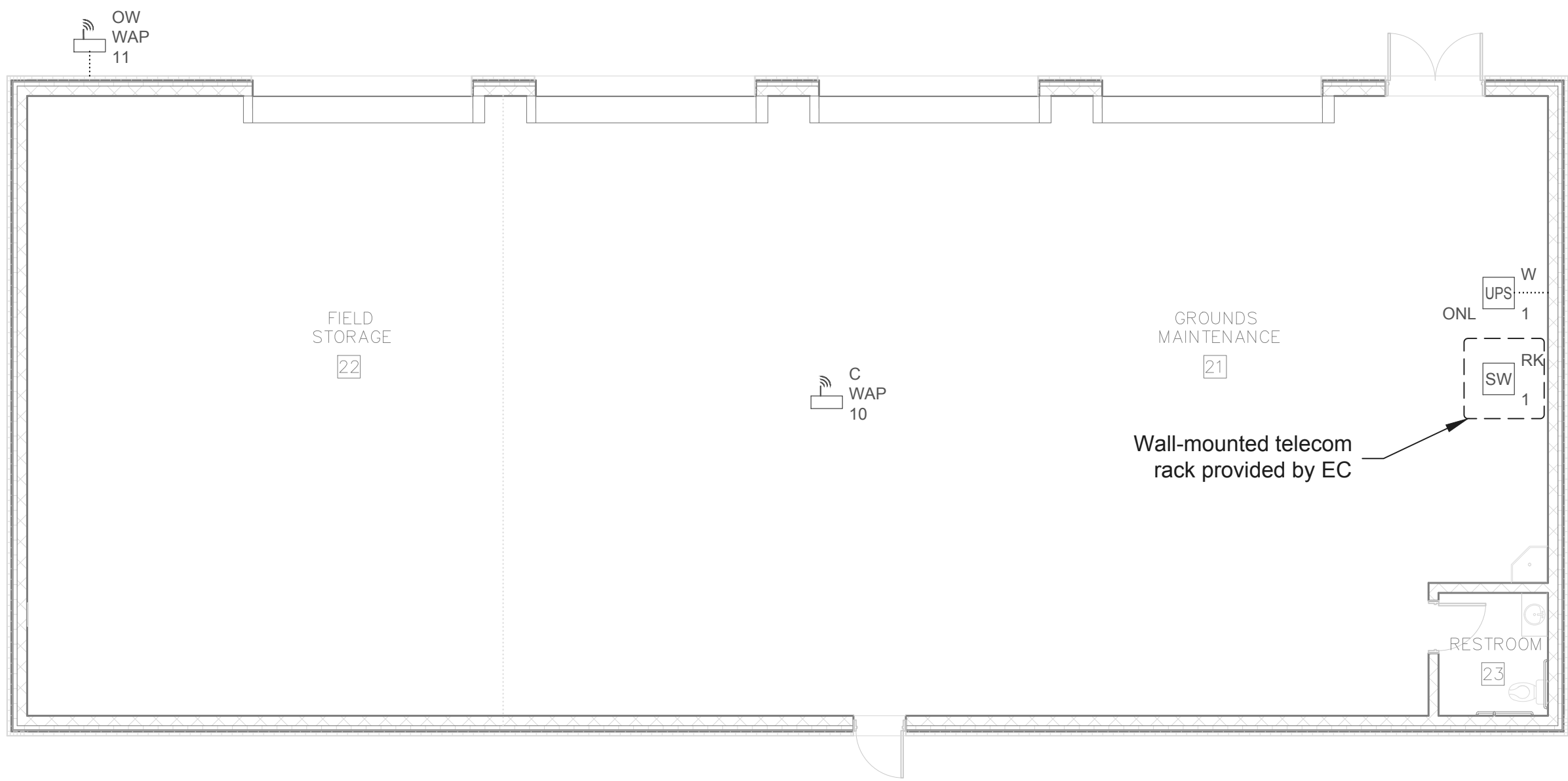

2 GROUNDS & FIELDS BUILDING FIRST FLOOR PLAN

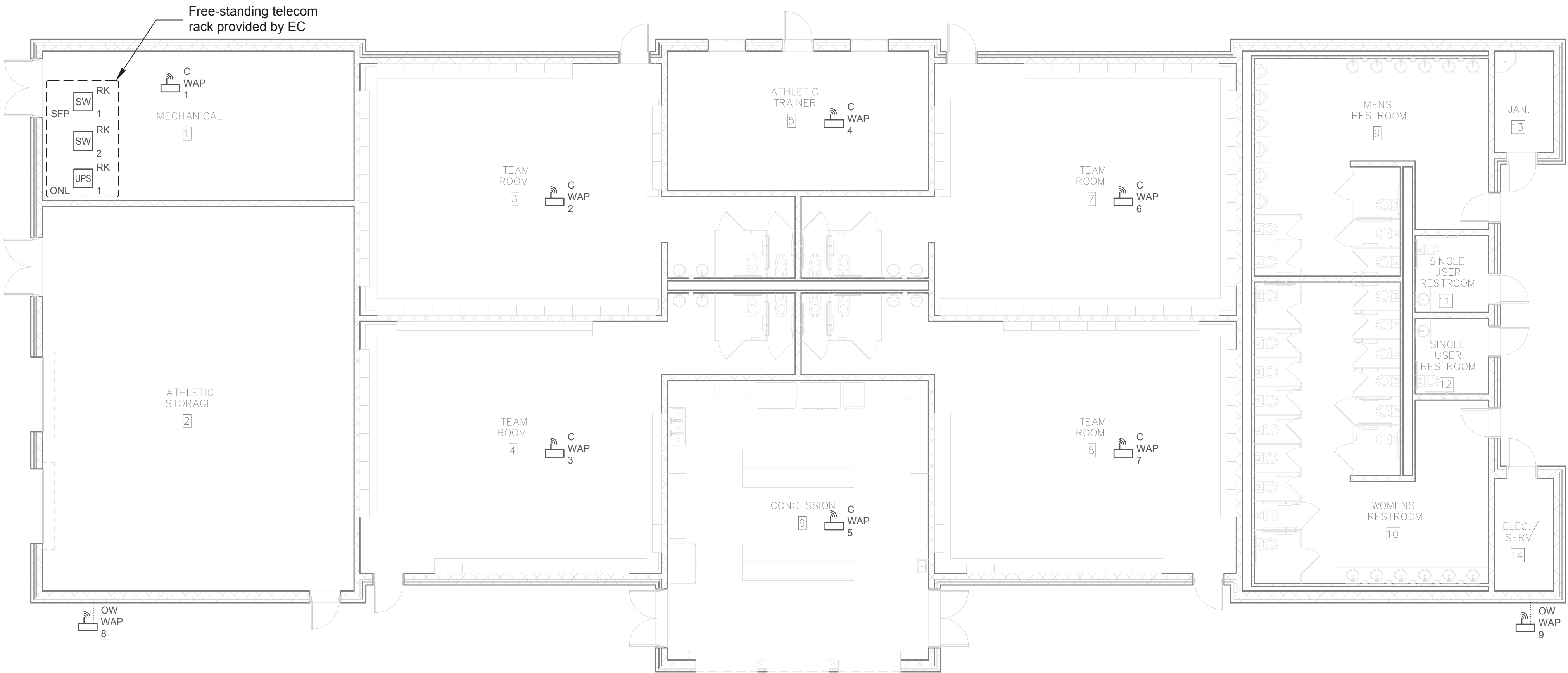

1 FIELD HOUSE FIRST FLOOR PLAN



PROJECT TEAM

Owner
Tredyffrin/Easttown School District
940 West Valley Road, Suite 1700
Wayne, PA 19087
610-240-1900

Architect
Heckendorn Shiles Architects
347 East Conestoga Road
Wayne, PA 19087
610-994-3500

Structural Engineer
A.W. Lookup Corporation
500 Fayette Street, Suite 100
Conshohocken, PA 19428
610-825-2600

MEPFP Engineer
Schiller and Hersh Assoc., Inc.
636 Skippack Pike, Suite 200
Blue Bell, PA 19422

Site/Civil
Pennoni Assoc., Inc.
One South Church Street, 2nd Floor
West Chester, PA 19382

IT Consultant
Teranet Consulting & Technical
Services
215-527-9825

Security
KtecK, Inc.
565 Meadowbrook Ave
Ambler, PA 19002
215-237-7390

Network
Saltant Solutions LLC
PO Box 252
Narberth, PA 19072-1924
267-551-4786

PROJECT

TESD Conestoga Athletic Fields
Tredyffrin Township
Chester County, PA

HSA Project #21-019

ISSUE HISTORY

CD	2024-03-18	Contract Documents
PI	2024-03-15	Progress Issue
MARK	DATE	DESCRIPTION

SHEET TITLE

SINGLE LINE
DIAGRAM

DRAWING NUMBER

T600

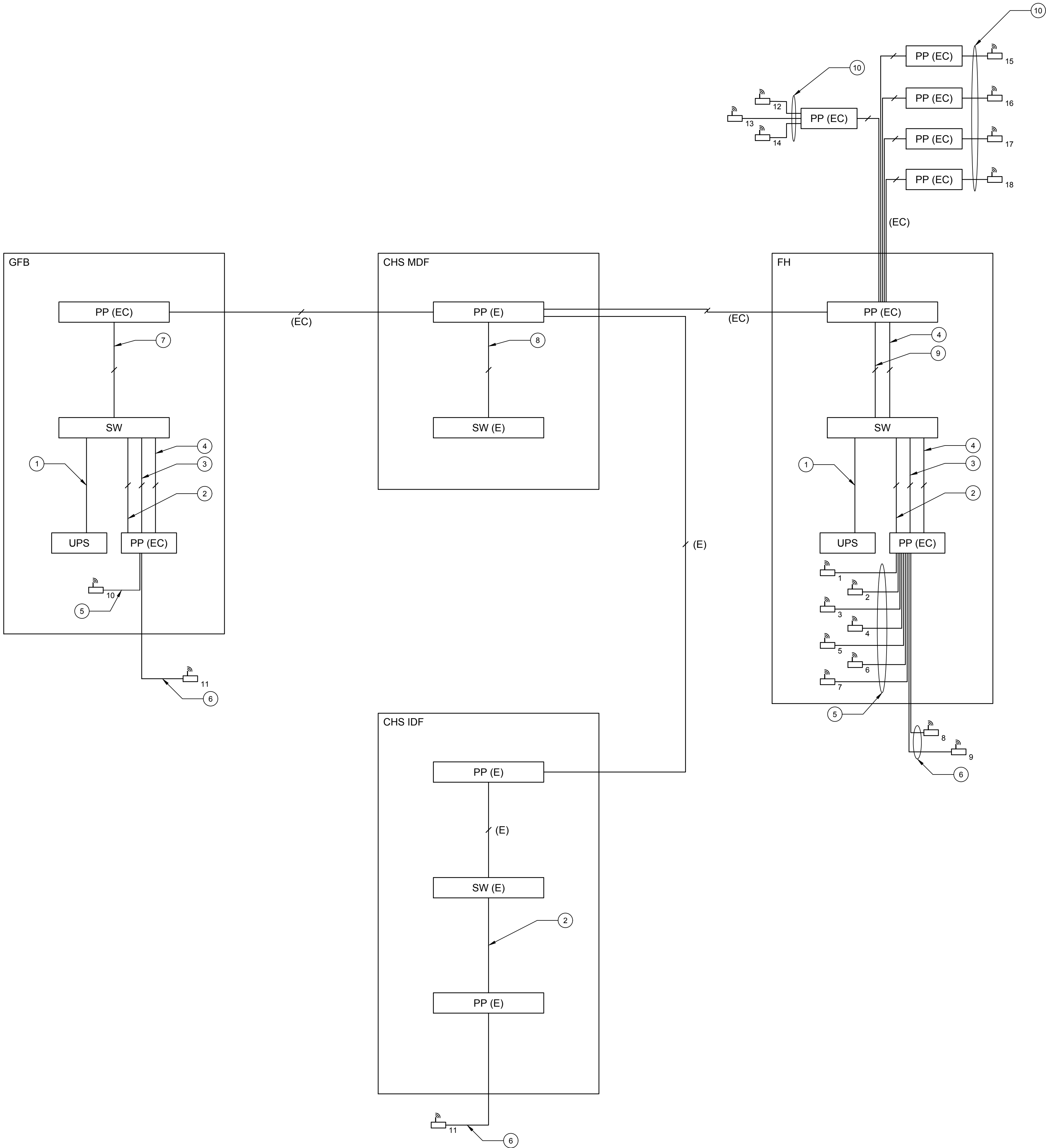

SHEET NOTES

- ① PROVIDE WHITE JACKET CAT 6A STP PATCH CABLE FOR UPS NETWORK MANAGEMENT.
- ② PROVIDE BLUE JACKET CAT 6A STP PATCH CABLE FOR EACH WAP.
- ③ PROVIDE BLUE JACKET CAT 6A STP PATCH CABLE FOR EACH CONVENIENCE PORT (EC). COORDINATE FINAL QUANTITY AND PATCH PANEL PORTS WITH EC.
- ④ CCTV SECURITY CAMERA CONNECTIONS BY SSI.
- ⑤ PROVIDE WHITE JACKET CAT 6A STP PATCH CABLE FROM FACE PLATE (EC) FOR EACH CEILING MOUNTED WAP.
- ⑥ PROVIDE CAT 6A STP INDUSTRIAL TEMPERATURE RATED PATCH CABLE IN FLEXIBLE CONDUIT BETWEEN EACH J-BOX (EC) AND OUTSIDE WALL MOUNTED WAP.
- ⑦ PROVIDE TWO (2) DUPLEX LC/LC UPC SMF PATCH CABLES AND TWO (2) 10G LR OPTICAL TRANSCEIVERS FOR SW UPLINK TO CHS MDF. COORDINATE PATCH PANEL PORTS WITH EC.
- ⑧ PROVIDE FOUR (4) DUPLEX LC/LC UPC SMF PATCH CABLES AND FOUR (4) 10G LR OPTICAL TRANSCEIVERS FOR SW UPLINK FROM FH IDF AND GFB IDF. COORDINATE PATCH PANEL AND SWITCH PORTS WITH TESD IT STAFF AND ENGINEER.
- ⑨ PROVIDE NINE (9) DUPLEX LC/LC UPC SMF PATCH CABLES AND NINE (9) 10G LR OPTICAL TRANSCEIVERS FOR SW UPLINK TO CHS IDF AND UPLINKS FROM REMOTE-MOUNTED WAPS. COORDINATE PATCH PANEL PORTS WITH EC.
- ⑩ PROVIDE INDUSTRIAL TEMPERATURE RATED DUPLEX LC/LC UPC SMF PATCH CABLE IN FLEXIBLE CONDUIT BETWEEN PP IN POLE-MOUNTED EQUIPMENT ENCLOSURE (EC) AND EACH WAP. COORDINATE FINAL DIMENSIONS IN THE FIELD. COORDINATE PATCH PANEL PORTS WITH EC.