

OWNER
West Chester Area School District
phone: 484.266.1281
CONTACT PERSON: Damon Gonzaga

CIVIL ENGINEER
Stantec Consulting Services
phone: 610.840.2500
CONTACT PERSON: Charles J. Olivo, PE

STRUCTURAL ENGINEER
Baker, Ingram & Associates
phone: 856.310.1491
CONTACT PERSON: Brian D. McGlade, PE

MEP & FP
Snyder Hoffman Associates, Inc
phone: 610.694.8020
CONTACT PERSON: Jeff Machik, PE

GAS LINE	-----
WATER LINE	- - - - -
STORM WATER LINE	- - - - -
SANITARY LINE	-----
COMMUNICATION LINE	-----

EXISTING BUILDING

PROPOSED ADDITION

1. ARCHITECTURAL SITE PLAN SHOWN FOR GENERAL LAYOUT AND COORDINATION ONLY. SEE CIVIL PLANS AND DRAWINGS FOR MORE INFORMATION AND DETAILS.
2. SEE CIVIL AND ELECTRICAL DRAWINGS FOR LOCATION OF ALL UTILITIES ENTERING THE SITE.

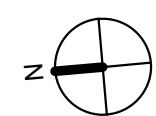

Mary C. Howse
Elementary

Sheet Title:
ARCHITECTURAL SIT
PLAN

Seal

TO STARTING WORK:
Any party who relies in part or whole on the content of these Construction Documents shall, before beginning work, make a diligent and careful inspection of the complete set of Contract Documents, including all Drawings, Specifications, and Addenda, for completeness, conflicts, scope of work, and suitability for constructing the building. All parties relying on these documents represent that they have expertise in the area of their responsibility and are responsible for understanding and interpreting the product requirements and code requirements and therefore are qualified to fully evaluate and interpret the contract documents. All parties relying on these documents must, prior to beginning work, submit all requests for clarifications and additional information to the Architect in writing. By signing these documents, the parties hereby certify that the documents are suitable for their intended purposes unless noted in specific written exception beforehand.

Warning: Actual conditions may vary from conditions shown on this drawing. Confirm all information in the field before proceeding with any work and notify the Architect in writing if a variation is discovered.

This drawing is not to be copied or transmitted in any form without the express written authorization of Blackney Hayes Architects. All ideas and concepts depicted or suggested in this drawing are the property of Blackney Hayes Architects.

[illegible]

BHA Job Number: 22-114

Scale: As indicated

Drawn By: BH

Checked By: NM

Approved By: DJ

Sheet No. _____

Abstract

AS100

AS 100

7.10.00

© Copyright 2023 Blackney Hayes Architects

NOT FOR CONSTRUCTION

AS1.00



phone: 215.829.0922 x###
CONTACT PERSON: PM Name

OWNER
West Chester Area School District
phone: 484.266.1281
CONTACT PERSON: Damon Gonzaga

CIVIL ENGINEER
Stantec Consulting Services
phone: 610.840.2500
CONTACT PERSON: Charles J. Olivo, PE

STRUCTURAL ENGINEER
Baker, Ingram & Associates
phone: 856.310.1491
CONTACT PERSON: Brian D. McGlade, PE

MEP & FP
Snyder Hoffman Associates, Inc
phone: 610.694.8020
CONTACT PERSON: Jeff Machik, PE

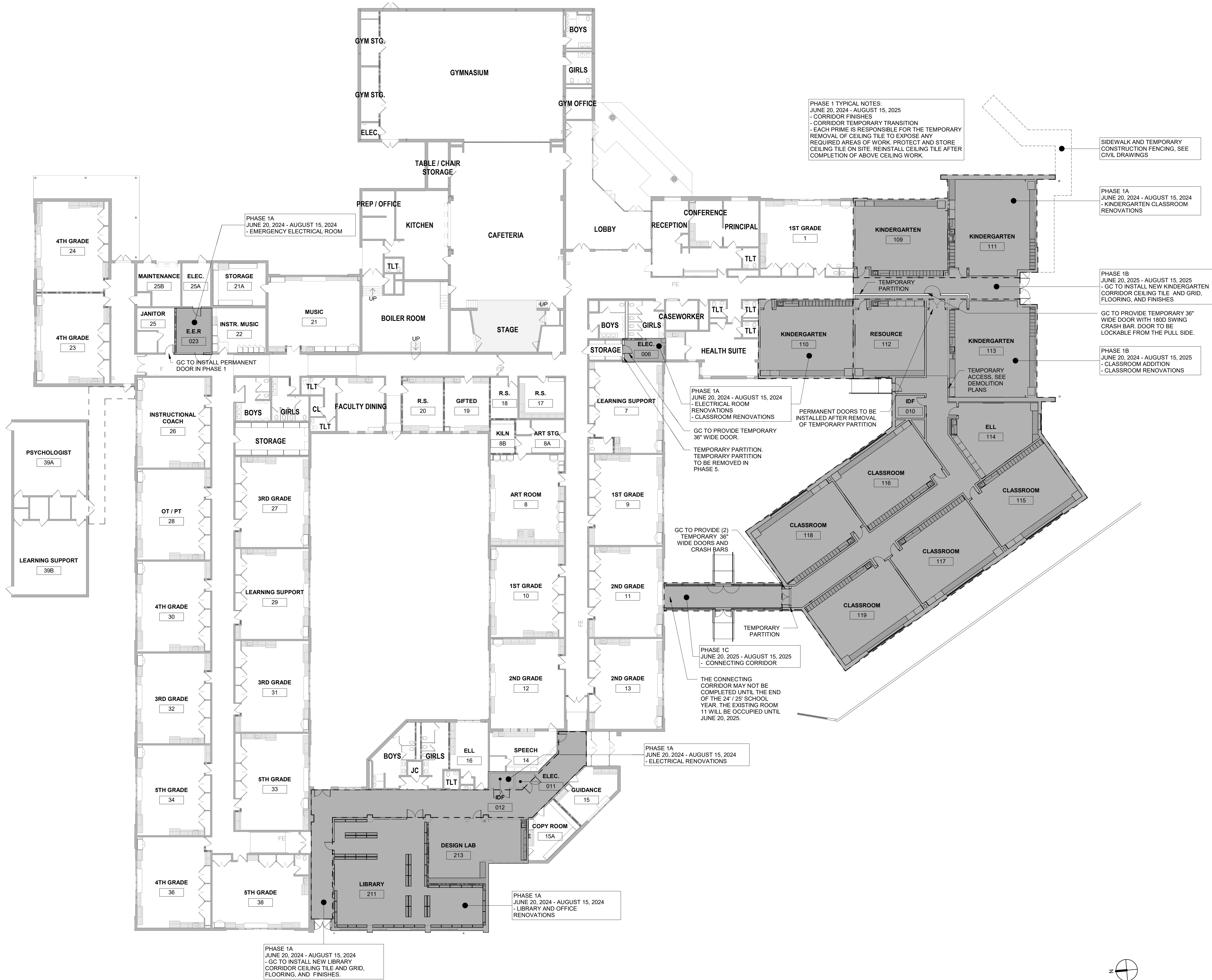

1 OVERALL EXISTING PLAN
1/16" = 1'-0"

Project:
Mary C. Howse Elementary

Project Address:
**641 Boot Road
West Chester, PA 19380**

Sheet Title:
PHASING PLAN

Seal

DUTY TO INSPECT CONTRACT DOCUMENTS PRIOR TO STARTING WORK
Any party who relies in part or whole on the content of these Construction Documents shall, before beginning any work, be responsible for fully inspecting the complete set of Contract Documents, including all Drawings, Specifications, and Addenda, for completeness, conflicts, scope of work, and suitability for constructing the building. All parties relying on these documents represent that they have expertise in the area of their responsibility and are knowledgeable regarding industry standards, product requirements and code requirements and therefore are qualified to fully evaluate and interpret the contract documents. All parties relying on these documents must, prior to beginning work, submit all requests for clarifications and additional information to the Architect in writing. All parties who begin work hereby certify that the documents are suitable for their intended purposes unless noted in specific written exception beforehand.

Warning: Actual conditions may vary from conditions shown on this drawing. Confirm all information in the field before proceeding with any work and notify the Architect in writing if a variation is discovered.

This drawing is not to be copied or transmitted in any form without the express written authorization of Blackney Hayes Architects. All ideas and concepts depicted or suggested in this drawing are the property of Blackney Hayes Architects.

Release	Date	Comments	
	03.24.2023	SCHEMATIC DESIGN	△
	05.28.2023	DESIGN DEVELOPMENT	
	07.28.2023	80% CD SET	
	09.19.2023	90% CD SET	
	10.31.2023	BID SET	

BHA Job Number: 22-114
Scale: 1/16" = 1'-0"
Drawn By: BH
Checked By: NM
Approved By: DJ
Sheet No.

PH1.00

© Copyright 2023 Blackney Hayes Architects



OWNER
West Chester Area School District
phone: 484.266.1281
CONTACT PERSON: Damon Gonzaga

STRUCTURAL ENGINEER
Baker, Ingram & Associates
phone: 856.310.1491
CONTACT PERSON: Brian D. McGlade, PE

MEP & FP
Snyder Hoffman Associates, Inc
phone: 610.694.8020
CONTACT PERSON: Jeff Machik, PE

Mary C. Howse
Elementary

Sheet Title:

PHASING PLAN

Seal

These Construction Documents shall, before beginning any work, be responsible for fully inspecting the complete set of Contract Documents, including all Drawings, Specifications, and Addenda, for completeness, conflicts, scope of work, and suitability for constructing the building. All parties relying on these documents represent that they have expertise in the area of their responsibility and knowledge regarding industry standards, product standards, and regulatory requirements and therefore are qualified to fully evaluate and interpret the contract documents. All parties relying on these documents must, prior to beginning work, submit all requests for clarifications and additional information to the Architect in writing. **All parties who begin work hereby certify that the documents are suitable for their intended purposes unless noted in specific written exception beforehand.**

Warning: Actual conditions may vary from conditions shown on this drawing. Confirm all information in the field before proceeding with any work and notify the Architect in writing if a variation is discovered.

This drawing is not to be copied or transmitted in any form without the express written authorization of Blackney Hayes Architects. All ideas and concepts depicted or suggested in this drawing are the property of Blackney Hayes Architects.

[illegible]

Scale: $1/16" = 1'-0"$

Checked By: NM

Sheet No.

PH2.00

© Copyright 2023 Blackney Hayes Architect

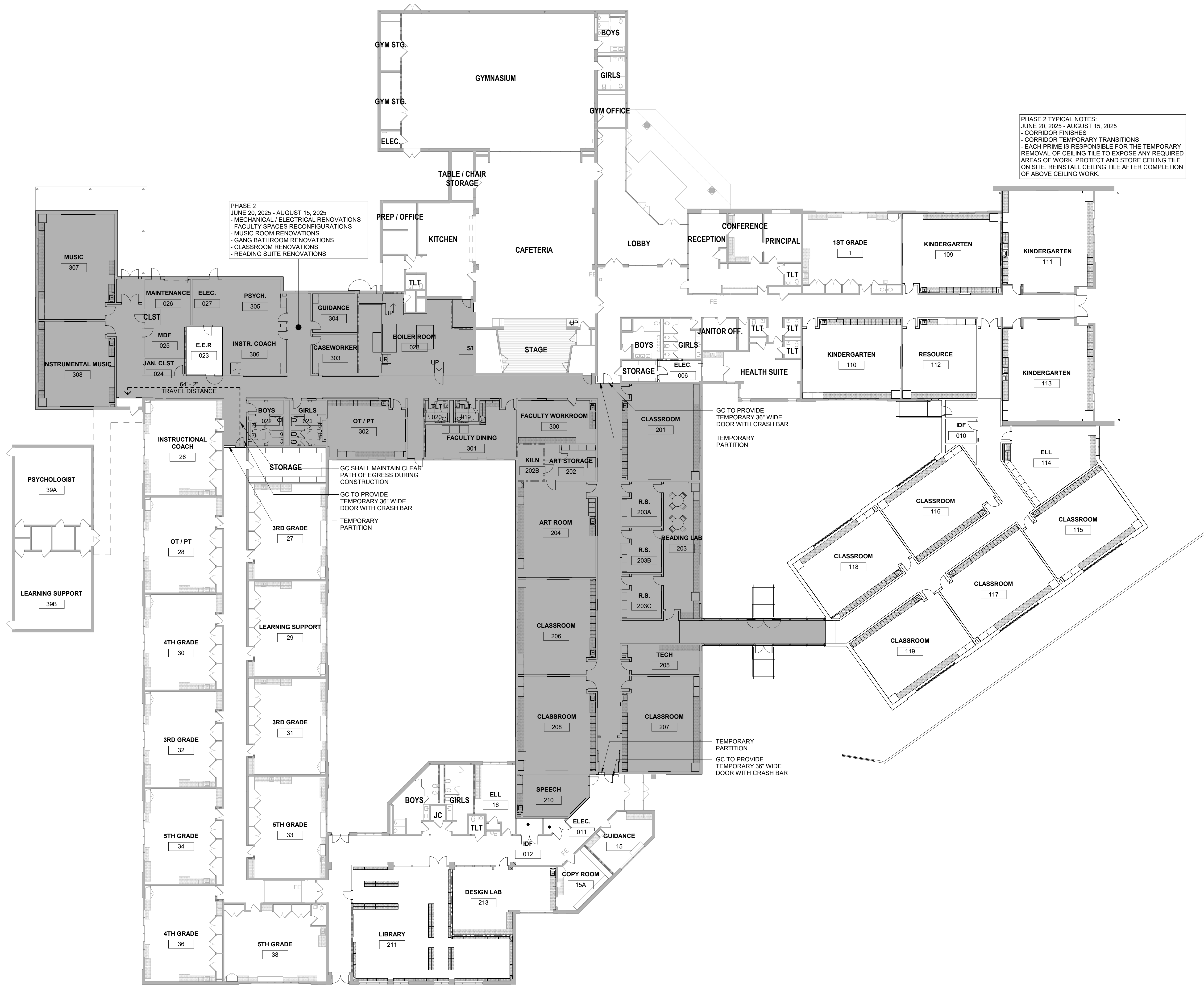

1 PHASING PLAN - PHASE 2
1/16" = 1'-0"

10/27/2023 10:22:46 AM

NOT FOR CONSTRUCTION



OWNER
West Chester Area School District
phone: 484.266.1281
CONTACT PERSON: Damon Gonzaga

STRUCTURAL ENGINEER
Baker, Ingram & Associates
phone: 856.310.1491
CONTACT PERSON: Brian D. McGlade, PE

MEP & FP
Snyder Hoffman Associates, Inc.
phone: 610.694.8020
CONTACT PERSON: Jeff Mach

PHASE 3 TYPICAL NOTES:
AUGUST 20, 2025 - DECEMBER 15, 2025
- CORRIDOR FINISHES
- CORRIDOR TEMPORARY TRANSITIONS
- EACH PRIME IS RESPONSIBLE FOR THE TEMPORARY REMOVAL OF CEILING TILE TO EXPOSE ANY REQUIRED AREAS OF WORK, PROTECT AND STORE CEILING TILE ON SITE, REINSTALL CEILING TILE AFTER COMPLETION OF ABOVE CEILING WORK.

SE 3
AUGUST 20, 2025 - DECEMBER 15, 2025
CLASSROOM RENOVATIONS

GC TO PROVIDE TEMPORARY 36" WIDE DOOR WITH CRASH BAR

TEMPORARY PARTITION

119'-4" TRAVEL DISTANCE

GC TO PROVIDE TEMPORARY 36" WIDE DOOR WITH CRASH BAR

ROOMS AND NUMBERS:

- GYM STG.
- GYMNASIUM
- BOYS
- GIRLS
- GYM OFFICE
- ELEC.
- TABLE / CHAIR STORAGE
- PREP / OFFICE
- KITCHEN
- CAFETERIA
- LOBBY
- CONFERENCE
- RECEPTION
- PRINCIPAL
- 1ST GRADE 1
- KINDERGARTEN 109
- KINDERGARTEN 111
- MAINTENANCE 026
- ELEC. 027
- PSYCH. 305
- CLST
- MDF 025
- E.E.R. 023
- INSTR. COACH 306
- JAN. CLST 024
- GUIDANCE 304
- CASEWORKER 303
- BOILER ROOM 028
- ST
- STAGE
- UP
- DOWN
- BOYS 022
- GIRLS 021
- OT / PT 302
- TLT 020
- TLT 019
- FACULTY WORKROOM 300
- FACULTY DINING 301
- KILN 202B
- ART STORAGE 202
- ART ROOM 204
- CLASSROOM 201
- R.S. 203A
- R.S. 203B
- R.S. 203C
- READING LAB 203
- HEALTH SUITE
- JANITOR OFF.
- STORAGE 006
- ELEC. 006
- KINDERGARTEN 110
- RESOURCE 112
- KINDERGARTEN 113
- ELL 114
- CLASSROOM 116
- CLASSROOM 118
- CLASSROOM 117
- CLASSROOM 119
- ELL 115
- CLASSROOM 206
- CLASSROOM 208
- CLASSROOM 207
- TECH 205
- CLASSROOM 316
- CLASSROOM 317
- CLASSROOM 318
- CLASSROOM 319
- CLASSROOM 320
- CLASSROOM 321
- LIBRARY 211
- DESIGN LAB 213
- COPY ROOM 15A
- GUIDANCE 15
- ELEC. 011
- IDF 012
- TLT 017
- JC
- BOYS
- GIRLS
- ELL 16
- SPEECH 210
- OT / PT 28
- INSTRUCTIONAL COACH 26
- PSYCHOLOGIST 39A
- LEARNING SUPPORT 39B
- INSTRUMENTAL MUSIC 308
- MUSIC 307

Mary C. Howse
Elementary

Sheet Title:

PHASING PLAN

DUTY TO INSPECT CONTRACT DOCUMENTS PRIOR

Warning: Actual conditions may vary from conditions shown on this drawing. Confirm all information in the field before proceeding with any work and notify the Architect in writing if a variation is discovered.

[illegible]

PH3.00

© Copyright 2022 Blackney Hayes Architect

1 PHASING PLAN - PHASE 3
1/16" = 1'-0"

NOT FOR CONSTRUCTION



OWNER
West Chester Area School District
phone: 484.266.1281
CONTACT PERSON: Damon Gonzaga

STRUCTURAL ENGINEER
Baker, Ingram & Associates
phone: 856.310.1491
CONTACT PERSON: Brian D. McGlade, PE

PHASE 4 TYPICAL NOTES:
JANUARY 19, 2026 - MAY 31, 2026
- CORRIDOR FINISHES
- CORRIDOR TEMPORARY TRANSITIONS
- EACH PRIME IS RESPONSIBLE FOR THE TEMPORARY
REMOVAL OF CEILING TILE TO EXPOSE ANY REQUIRED
AREAS OF WORK. PROTECT AND STORE CEILING TILE ON
SITE. REINSTALL CEILING TILE AFTER COMPLETION OF
ABOVE CEILING WORK.

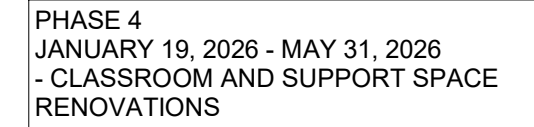

Project Address:
641 Boot Road
West Chester, PA 19380

PHASING PLAN

Seal

Warning: Actual conditions may vary from conditions shown on this drawing. Confirm all information in the field before proceeding with any work and notify the Architect in writing if a variation is discovered.

Date	Comments	
03.24.2023	SCHEMATIC DESIGN	
05.26.2023	DESIGN DEVELOPMENT	
07.28.2023	60% CD SET	
09.19.2023	90% CD SET	
0.31.2023	BID SET	

Date	Comments	
23.03.2023	SCHMATIC DESIGN	
25.06.2023	DESIGN DEVELOPMENT	
27.08.2023	60% CD SET	
19.10.2023	90% CD SET	
0.31.2023	BID SET	

PH4.00

© Copyright 2022 Blackney Hayes Architect

1 PHASING PLAN - PHASE 4
1/16" = 1'-0"

NOT FOR CONSTRUCTION



OWNER
West Chester Area School District
phone: 484.266.1281
CONTACT PERSON: Damon Gonzaga

STRUCTURAL ENGINEER
Baker, Ingram & Associates
phone: 856.310.1491
CONTACT PERSON: Brian D. McGlade, PE

Mary C. Howse
Elementary

Sheet Title:

Seal

TO STARTING WORK:
Any party who relies in part or whole on the content of these Construction Documents shall, before beginning construction, conduct a thorough inspection of the complete set of Contract Documents, including all Drawings, Specifications, and Addenda, for completeness, conflicts, scope of work, and suitability for constructing the building. All parties relying on these documents represent and warrant that they have read and understood the documents that they have expertise in the area of their responsibility and that they are satisfied that the documents set forth, product requirements and code requirements and therefore are qualified to fully evaluate and interpret the contract documents. All parties relying on these documents must, prior to beginning work, submit all requests for clarifications and additional information to the Architect in writing. The parties hereby warrant and hereby certify that the documents are suitable for their intended purposes unless noted in specific written exception beforehand.

Warning: Actual conditions may vary from conditions shown on this drawing. Confirm all information in the field before proceeding with any work and notify the Architect in writing if a variation is discovered.

This drawing is not to be copied or transmitted in any form without the express written authorization of Blackney Hayes Architects. All ideas and concepts depicted or suggested in this drawing are the property of Blackney Hayes Architects.

Release		
Date	Comments	△
03.24.2023	SCHEMATIC DESIGN	
05.26.2023	DESIGN DEVELOPMENT	
07.28.2023	60% CD SET	
09.19.2023	90% CD SET	
0.31.2023	BID SET	

Sheet No. _____

© Copyright 2023 Blackney Hayes Architect

NOT FOR CONSTRUCTION



10/27/2023 10:22:58 AM